

CAREFULLY READ THE INSTRUCTIONS BEFORE INSTALLING

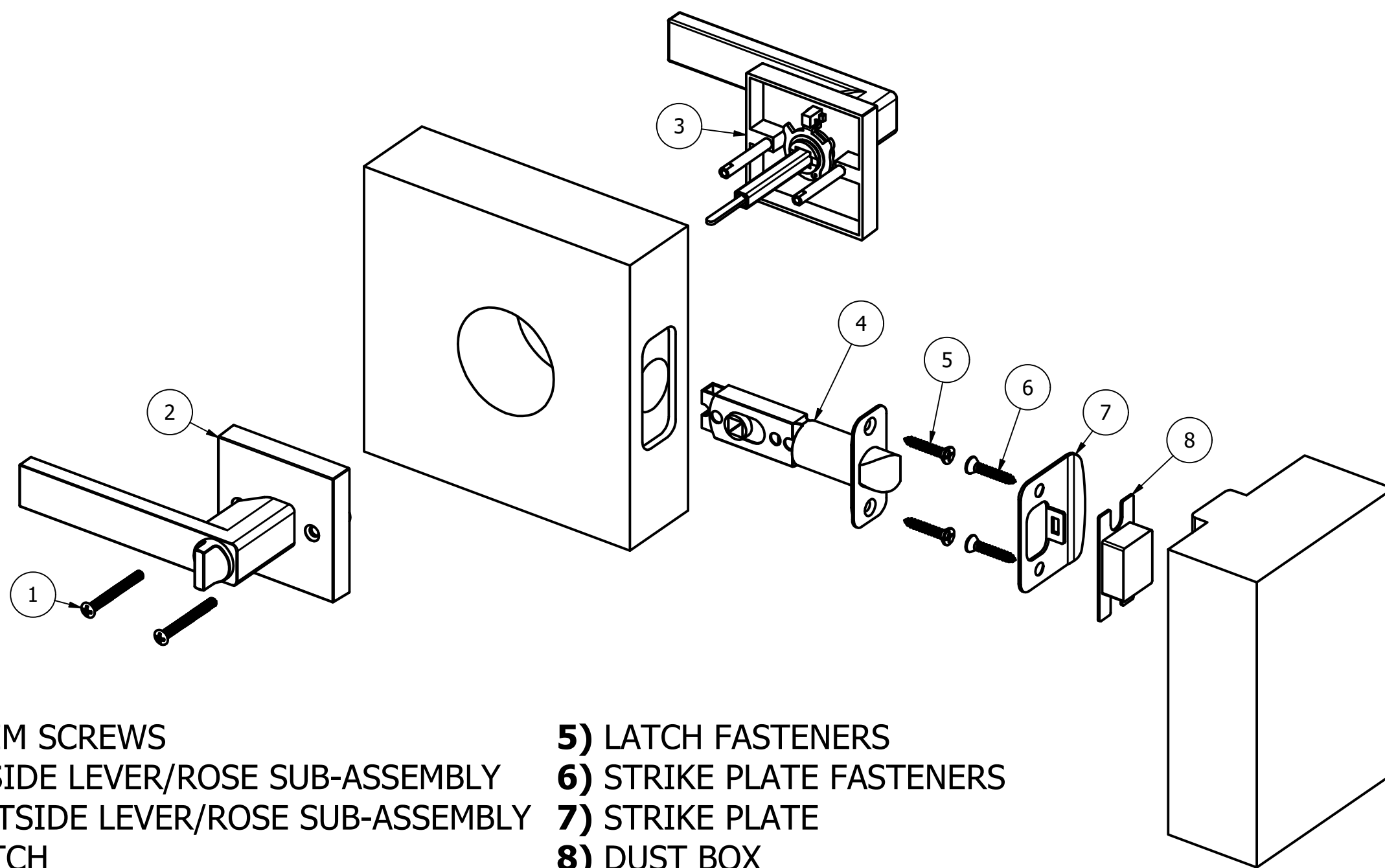

1) TRIM SCREWS

2) INSIDE LEVER/ROSE SUB-ASSEMBLY

3) OUTSIDE LEVER/ROSE SUB-ASSEMBLY

4) LATCH

5) LATCH FASTENERS

6) STRIKE PLATE FASTENERS

7) STRIKE PLATE

8) DUST BOX

STEP 1)

A) PREPARE THE DOOR ACCORDING TO DOOR PREPARATION GUIDE **DP-462**.

B) PREPARE THE STRIKE ACCORDING TO **DP-327** AND INSTALL THE STRIKE PLATE.

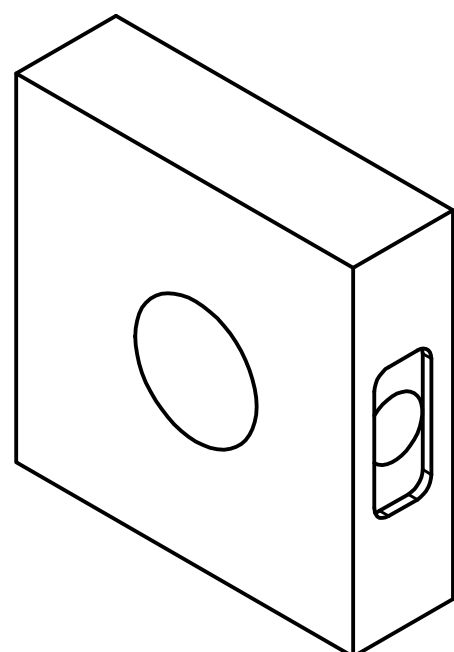

STEP 2)

SELECT THE DESIRED LATCH BACKSET BY SLIDING THE SPINDLE HUB, ACCORDING TO THE DOOR PREPARATION, 2-3/8" OR 2-3/4." (SHOWN AT 2-3/4")

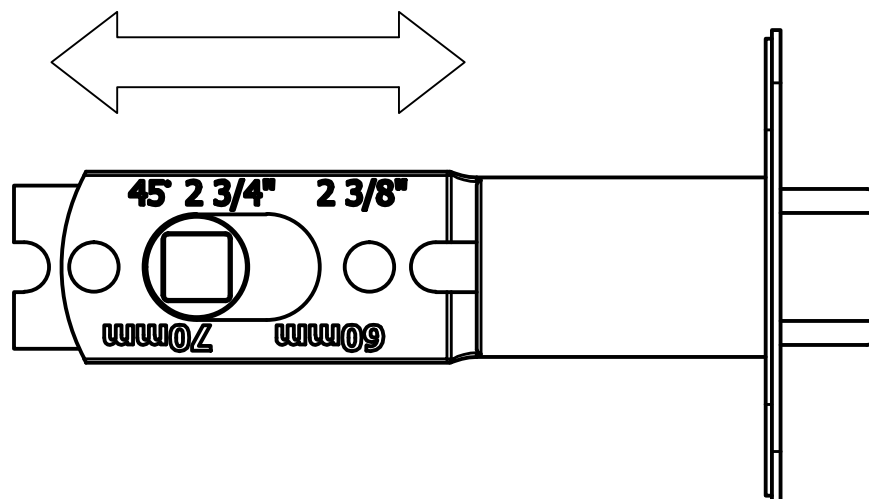

STEP 3)

WITH THE LATCH BOLT BEVEL ORIENTED IN THE CORRECT DIRECTION, INSERT THE LATCH (4) INTO THE DOOR AND SECURE IN PLACE WITH THE PROVIDED FASTENERS (5).

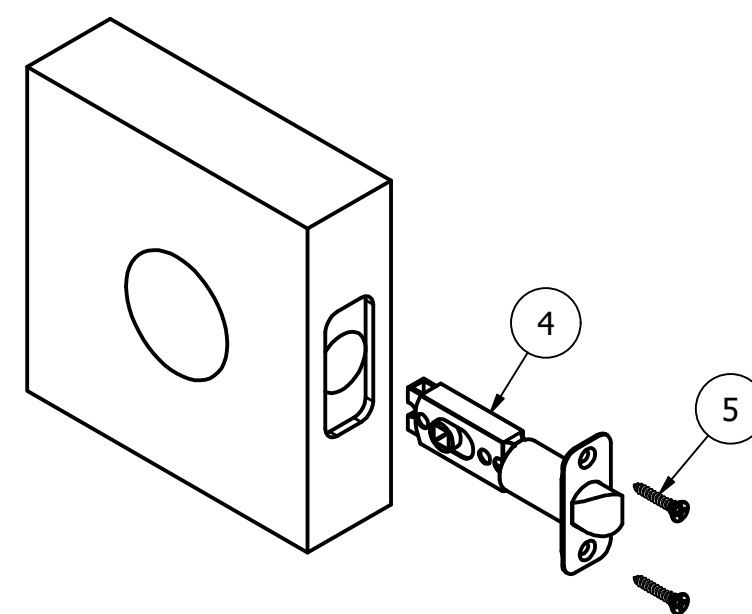

STEP 4)

INSERT THE OUTSIDE LEVER-ROSE SUB-ASSEMBLY (3) SO THAT THE SPINDLE AND TWO POSTS GO THROUGH THE CORRESPONDING HOLES IN THE LATCH, WITH THE ROSE FLUSH WITH THE DOOR SURFACE.

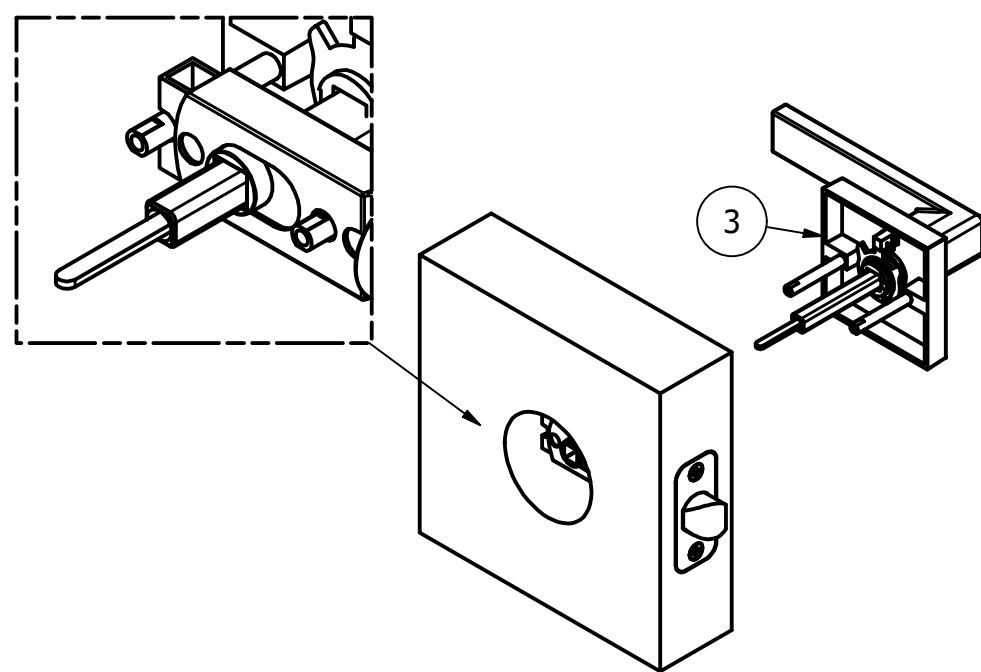

STEP 5)

A) INSERT THE INSIDE LEVER (2), CAREFULLY ALIGNING THE SCREW HOLES WITH THE POSTS. **B)** HOLD THE LEVERS-ROSE SUB-ASSEMBLIES IN THE CORRECT POSITION WHILE FASTENING TOGETHER WITH THE PROVIDED SCREWS (1).

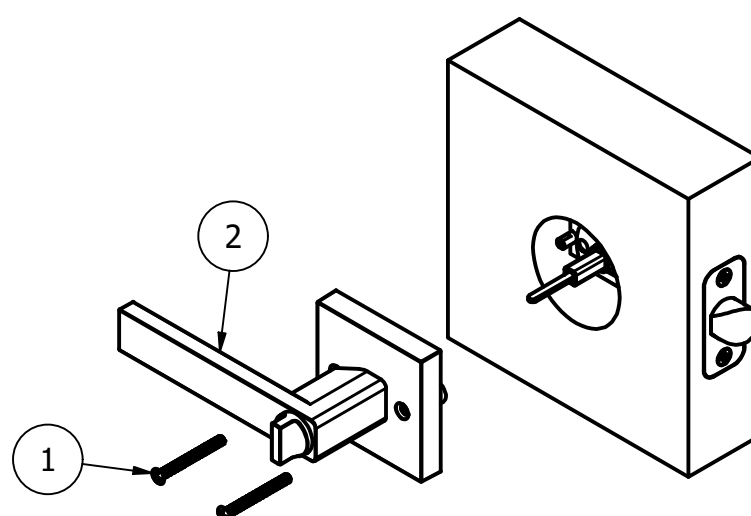

STEP 6)

USE THE FOLLOWING STEPS TO CHECK FOR PROPER FUNCTION BEFORE CLOSING DOOR:
A) ROTATE EACH LEVER TO VERIFY THAT THE LATCH BOLT RETRACTS.
B) VERIFY THAT THE LATCH BOLT ENGAGES THE STRIKE WHEN THE DOOR IS CLOSED.
C) VERIFY THAT THE LOCK MECHANISM WORKS.

