

930 | Aton

LEVERS



Shown in Satin Chrome finish

Standard rose system

Lever with 65 mm rose for standard tubular 2-1/8" door prep

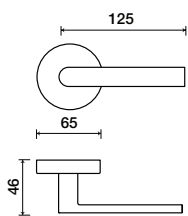

See "Rose Options" page for available rose options

Small rose system

Lever with 52 mm rose for mortise and custom tubular door prep

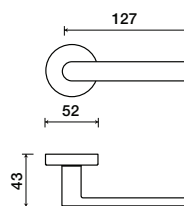

Escutcheon plate system

Lever with plate for mortise functions

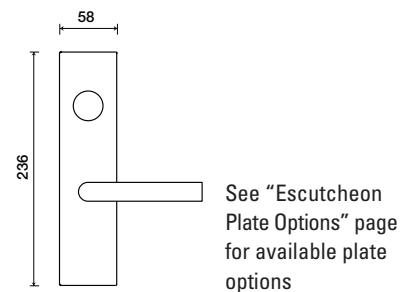

Tubular leversets ordering example:

Aton lever on a small rose, passage function, in satin stainless finish with 2-3/4" backset

930	SM	PA	626	2-3/4	
Lever design	Rose/Plate	Function	Finish	Backset	Misc.
Aton 930	SMQ (54mm) SMQR (54mm) SM (52mm) 1912Q (65mm) 1912 (65mm)	PA (Passage) PY (Privacy) FD (Full Dummy) SD (Single Dummy)	Per project specification	2-3/8" 2-3/4"	