

6118 | Lorenzo

LEVERS



Shown in Satin Stainless finish

Standard rose system

Lever with 65 mm rose for standard tubular 2-1/8" door prep

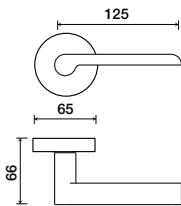

See "Rose Options" page for available rose options

Small rose system

Lever with 52 mm rose for mortise and custom tubular door prep

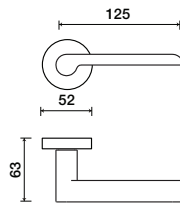

Escutcheon plate system

Lever with plate for mortise functions

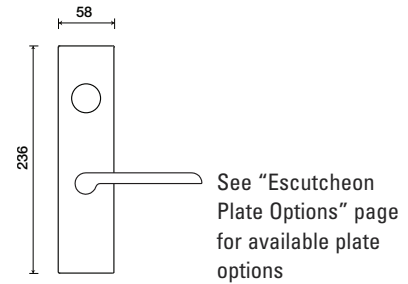

Tubular leversets ordering example:

Lorenzo lever on a standard rose, passage function, in satin stainless with 2-3/4" backset

6118	1912	PA	US32D	2-3/4	
Lever design	Rose/Plate	Function	Finish	Backset	Misc.
Lorenzo 6118	1912 (65 mm) SM (52 mm)	PA (Passage) PY (Privacy) FD (Full Dummy) SD (Single Dummy)	Per project specification	2-3/8" 2-3/4"	