



5850 | Christina

LEVERS



Cross-section profile is a flattened oval tilted away from the door

Shown in Bi-color Polished/Satin Stainless

Standard rose system

Lever with 65 mm rose for standard tubular 2-1/8" door prep

Small rose system

Lever with 52 mm rose for mortise and custom tubular door prep

Escutcheon plate system

Lever with plate for mortise functions

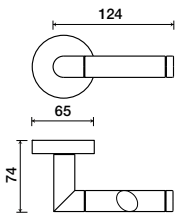

See "Rose Options" page for available rose options

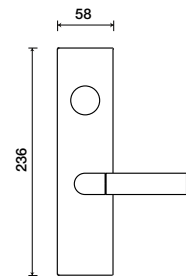
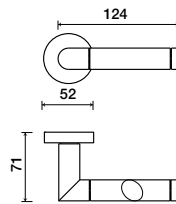

See "Escutcheon Plate Options" page for available plate options

Tubular leversets ordering example:

Christina lever on a standard rose, passage function, in polished/satin stainless with 2-3/4" backset

5850	1912	PA	US32/32D	2-3/4	
Lever design	Rose/Plate	Function	Finish	Backset	Misc.
Christina 5850	1912 (65 mm) SM (52 mm)	PA (Passage) PY (Privacy) FD (Full Dummy) SD (Single Dummy)	Per project specification	2-3/8" 2-3/4"	