

# Architectural Hinges

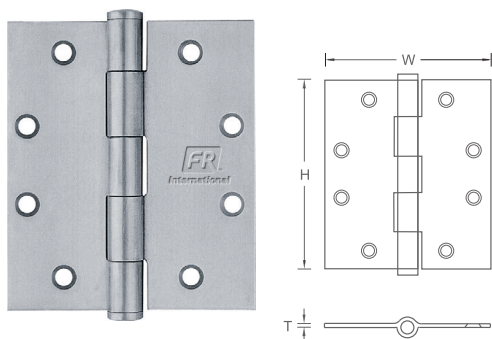

**HP Plain Bearing Hinge**

Model No.	Dimensions (H, W, T)
HP 3.5 x 3.5	3.5" x 3.5" x .119"
HP 4 x 4	4" x 4" x .129"
HP 4.5 x 4	4.5" x 4" x .134"
HP 4.5 x 4.5	4.5" x 4.5" x .134"
HP 5 x 4.5	5" x 4.5" x .145"

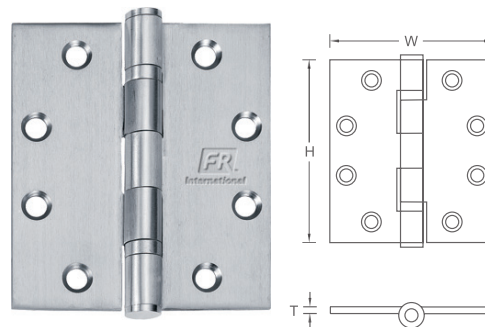

**2BB Standard Weight Hinge**

Model No.	Dimensions (H, W, T)
2BBH 3.5 x 3.5	3.5" x 3.5" x .119"
2BBH 4 x 4	4" x 4" x .129"
2BBH 4.5 x 4	4.5" x 4" x .134"
2BBH 4.5 x 4.5	4.5" x 4.5" x .134"
2BBH 5 x 4.5	5" x 4.5" x .145"

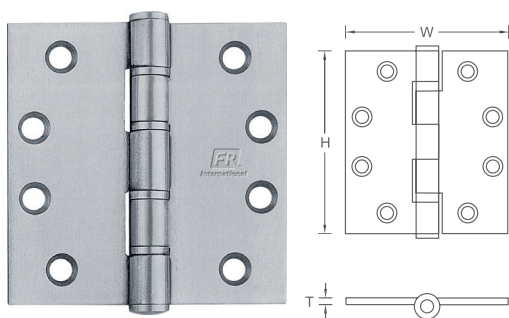

**HD4BBH Heavy Weight Hinge**

Model No.	Dimensions (H, W, T)
HD4BBH 4.5 x 4	4.5" x 4" x .180"
HD4BBH 4.5 x 4.5	4.5" x 4.5" x .180"
HD4BBH 5 x 4.5	5" x 4.5" x .190"
HD4BBH 5 x 5	5" x 5" x .190"

## Finish Options

630	Satin Stainless Steel
629	Polished Stainless Steel
605	Polished Brass
606	Satin Brass
609	Antique Brass
619	Satin Nickel
622	Matte Black
695	Dark Bronze
IXBSB	Brushed Satin Black PVD
IXCPN	Satin Champagne PVD
IXPCPN	Polished Champagne PVD

Additional finishes may be available, please contact factory.

# Architectural Hinges - General Information

## Standards

Hinges are manufactured in accordance with ANSI/BHMA A156.1.

## Types

Hinges are Full Mortise. Both leaves are mortised, one leaf in the door and one leaf in the frame.

## Selecting the Proper Weight and Bearing Structure

Due to the variety of door sizes, materials and weights, hinges are placed into three categories:

**Heavy Weight:** Ball Bearing (HD4BBH Series)

**Standard Weight:** Ball Bearing (2BBH Series)

**Standard Weight:** Plain Bearing (HP Series)

## Hinge Type Minimum Cycle Requirements

Plain Bearing = 350,000 cycles

Standard Weight Ball Bearing = 1,500,000 cycles

Heavy Weight Ball Bearing = 2,500,000 cycles

## Hinge Base Material

Stainless Steel (standard on all hinges)

## Security Feature

Available with the Non-Removable Pin (NRP) option. The barrel is drilled and tapped to receive a small set screw which is tightened against the hinge pin. The pin includes a groove to accept the set screw. The set screw may only be accessed when the door is in the open position.

## Hinge Tip

Supplied with standard Flat Button Tips

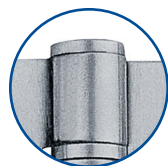

## Standard Screw Pack Information for Full Mortise Architectural Hinges

Part No.	Size	Screws
HP Series	3-1/2" and 4"	AWS & 1/2 MS
HP Series	4-1/2" and 5"	AMS & 1/2 WS
2BBH Series	3-1/2" and 4"	AWS & 1/2 MS
2BBH Series	4-1/2" and 5"	AMS & 1/2 WS
HD4BBH Series	4-1/2" and 5"	AMS & 1/2 WS

## Fastener Details

- 3-1/2" hinges supplied with 10-24 x 1/2" Machine Screws and #9 x 1" Wood Screws
- 4", 4-1/2" and 5" hinges supplied with 12-24 x 1/2" Machine Screws and #12 x 1-1/4" Wood Screws

## Care and Maintenance

- Hinges should be installed with no binding. The use of shims to properly align hinges, as required, is acceptable. On fire rated doors, shims must be steel.
- Hinges should be well greased and check regularly for proper lubrication.
- WD-40 and other similar products are not recommended for hinge lubrication.
- To clean, simply wipe with soft damp cloth. Abrasive cleaners should not be used. The use of abrasive cleaner or any paint thinner will void the warranty of the product.

## Warranty Information

- 5 years from date of delivery
- Covers defects in workmanship and materials under normal use and service
- The warranty does not cover damage from improper installation, misuse, or failure to maintain hinges

